



C. Brenner, Inc.

3586 Aloma Ave Suite 5
Winter Park, FL 32792
Phone: (407) 677-1700

COMMERCIAL REAL ESTATE

Warehouse and Huge Yard Downtown Orlando

**800 W Gore St,
Orlando, FL 32805**



- 6,800 SF warehouse/office on 1.5 acre paved site
- Fully fenced and paved lot with remote control gate access
- 3 phase 1000 amp power
- 20' clear height
- Ingress/Egress on W Gore St and Piedmont St
- Excellent central location with proximity to Downtown Orlando, I-4 and 408
- 600' from I-4 on ramp
- Close to stadiums, Creative Village and Sports & Entertainment District
- I-G zoning great for landscaping, contractor yard, equipment leasing/sales
- \$17,500/month NNN

Ben Brenner
Lic. RE Broker
C. Brenner Inc.

Cell: 407-970-6447
Office: 407-677-1700
Email: bbrenner@cbrenner.com

Expect Results with C Brenner Inc!
www.cbrenner.com



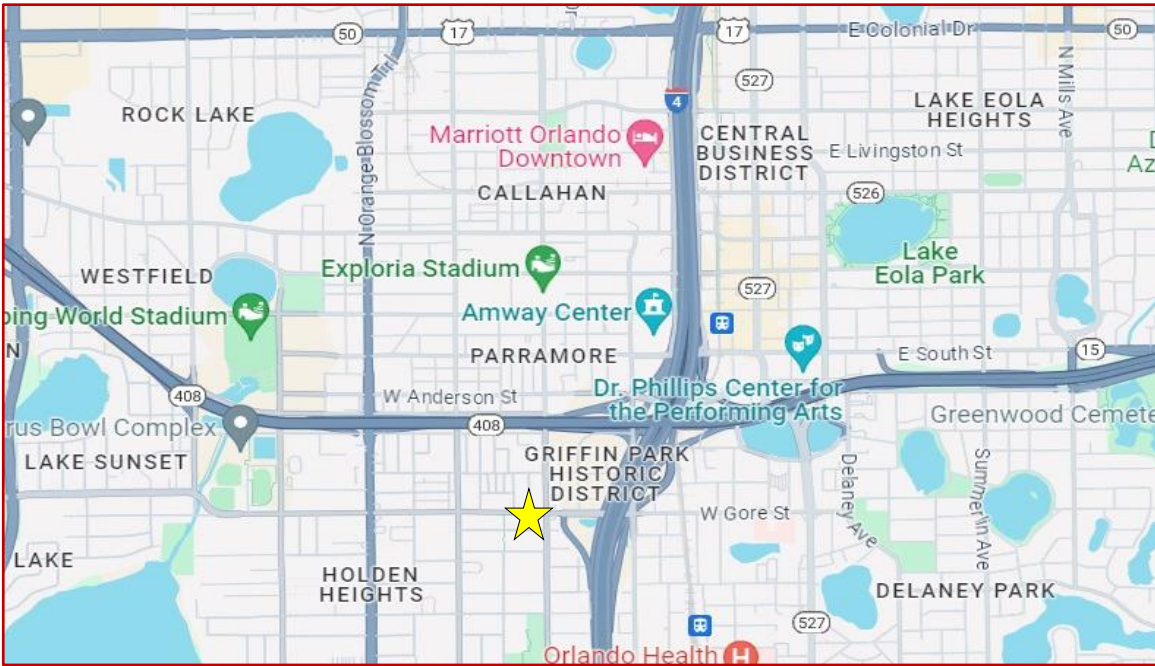

1st Floor

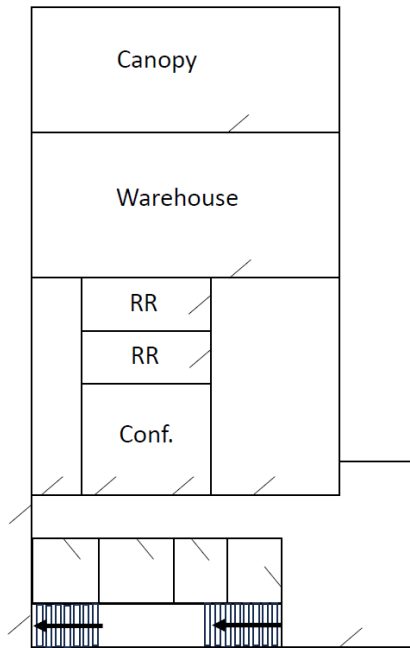

2nd Floor

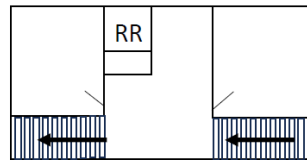

Expect Results with C Brenner Inc!

www.cbrenner.com